

Components for BZC Control Stations

HA Flameproof pushbutton



- ◆ Explosion protection to
 - CENELEC
 - IEC
 - NEC
- ◆ Can be used in
 - Zone 1 and Zone 2
 - Zone 21 and Zone 22
 - Class I, Zone 1 and Zone 2
 - Class I, Division 1, Groups A, B, C, D
- ◆ Five different ways of operation
 - Spring-return pushbutton
 - Key-operated pushbutton
 - Mushroom stay-put emergency pushbutton
 - Mushroom turn-to-release emergency pushbutton
 - Rotary pushbutton
- ◆ Mushroom stay-put emergency pushbutton/ mushroom turn-to-release emergency pushbutton can be equipped with protection cover, please specify when ordering. Material of protection cover: stainless steel and PC, please specify when ordering.

■ Catalogue number logic

HA (A for short)

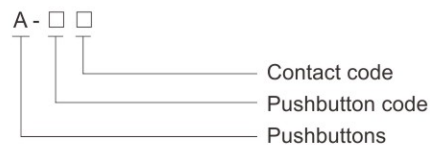

Technical data

HA Flameproof pushbutton

Explosion protection

Global (IECEX)
Gas and dust

IECEX CML 17.0161U

Ex db IIC Gb

Ex tb IIIC Db

Europe (ATEX)

CML 17 ATEX 1289U

Gas and dust

⊕ II 2 G Ex db IIC Gb

⊕ II 2 D Ex tb IIIC Db

Certificates

Conformity to standards

IECEX; ATEX

EN 60079-0, EN 60079-1, EN 60079-31

IEC 60079-0, IEC 60079-1, IEC 60079-31

Rated voltage

660V AC; 440V DC

Rated current

10A (for 660V AC); 6A (for 440V DC)

Degree of protection

IP66

Ambient temperature

-60°C~+70°C

Zones 1&2; 21&22

Components for BZC Control Stations

HA Flameproof pushbutton

Selection table					
Cover mounting	Specification	Code	Ordering code	Weight (kg)	
	Spring-return pushbutton	● Red	a	40036A	0.15
		● Green	b	40036B	0.15
		● Yellow	c	40036C	0.15
		● Black	d	40036D	0.15
	Mushroom stay-put emergency pushbutton	Red	d	40037	0.27
	Key-operated mushroom stay-put emergency pushbutton	Red	d	40037A	0.30
	Mushroom turn-to-release emergency pushbutton	Red	e	40040	0.27
	Key-operated mushroom turn-to-release emergency pushbutton	Red	e	40040A	0.30
	Rotary pushbutton	Black	f	40039	0.27
	Key-operated pushbutton	Black	g	40038	0.27
	Pushbutton with indicator	● Red	a	40057A	0.15
		● Green	b	40057B	0.15
		● Yellow	c	40057C	0.15
		● Blue	d	40057D	0.15





Components for BZC Control Stations HA Flameproof pushbutton

Selection table of pushbutton contact

Version	Specification	Contact code	Ordering code	Weight (kg)
 Screw type	 1NC	T1	40023	0.03
	 1NO	S1	40024	0.03

Accessories

Description	Material	Ordering code	Weight (kg)
 Emergency pushbutton protection cover	PC	40196	0.03
 Emergency pushbutton protection cover	Stainless steel	40197	0.15



Dimension drawings (all dimensions in mm) - subject to alteration

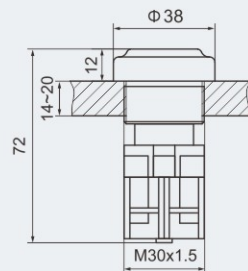

Flameproof Thread
Spring-return pushbutton

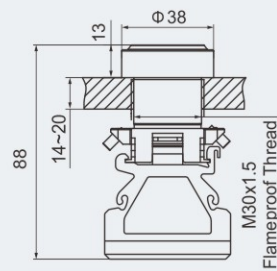

M30x1.5
Flameproof Thread
Pushbutton with indicator

Components for BZC Control Stations HA Flameproof pushbutton

Dimension drawings (all dimensions in mm) - subject to alteration

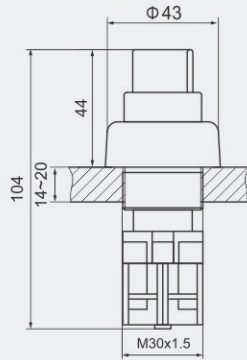

Flameproof Thread
Rotary pushbutton

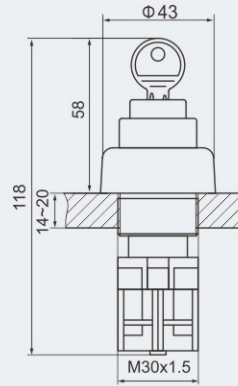

Flameproof Thread
Key-operated pushbutton

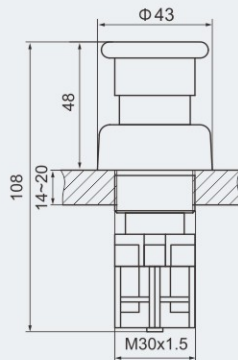

Flameproof Thread
Mushroom stay-put/ turn-to-release
emergency pushbutton

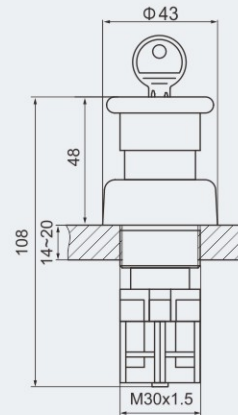

Flameproof Thread
Key-operated mushroom
stay-put emergency
pushbutton

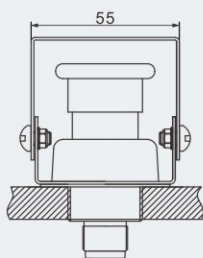

HA Emergency pushbutton with
stainless steel protection cover

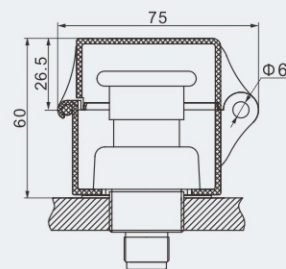
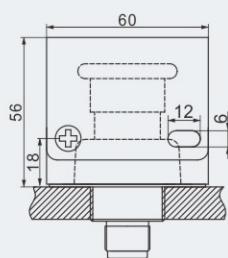

HA Emergency pushbutton with
PC protection cover

